

720 MAIN

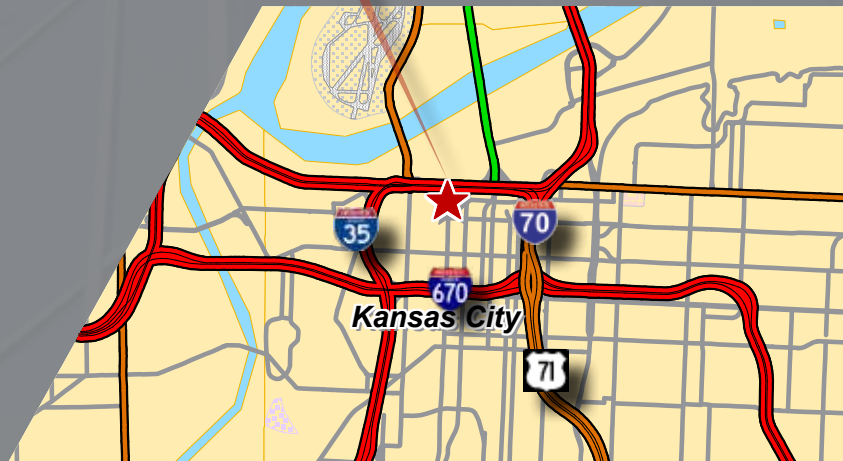

For additional information, please contact:

Greg Swetnam
816.936.8510
gswetnam@kessingerhunter.com

Debbie Schulte, SIOR
816.936.8549
dschulte@kessingerhunter.com

CUSHMAN & WAKEFIELD | **KESSINGER HUNTER**
COMMERCIAL REAL ESTATE SINCE 1879
INDEPENDENTLY OWNED AND OPERATED
2600 Grand Blvd., Suite 700 | Kansas City, MO 64108
Phone: 816.842.2690 | Fax: 816.421.5659



EXECUTIVE PLAZA

720 MAIN
KANSAS CITY, MO



CUSHMAN & WAKEFIELD | **KESSINGER HUNTER**
COMMERCIAL REAL ESTATE SINCE 1879
INDEPENDENTLY OWNED AND OPERATED

600 Grand Blvd., Suite 700 | Kansas City, MO 64108
Phone: 816.842.2690 | Fax: 816.421.5659

720 MAIN

FOR SALE

Location - Executive Plaza is located a short walk away from the brand new \$850 million Power & Light District. Its location on the north side of Downtown provides immediate access to and from the Main Street I-70/I-35 access ramps for easy access to the airport and all other parts of the KC Metro area.

Views - Its north Downtown location afford four sides of striking views not available at other properties in the Central Business District.

Flexibility - 720 Main has flexible, large 20,900 SF floor plates. The entire building was occupied by Commerce Bank for its operations center through 2006.

Building Description

Executive Plaza is a nine-story office building containing 207,421 usable SF of space. The building is constructed with steel and concrete and a distinctively contemporary reflective glass curtain-wall.

Sale Price

\$3,500,000

Building Size

207,421 SF

Land Size

42,175 SF

Floors

Nine floors plus lower level

Year Built

1973

Elevators

Four passenger elevators; one freight elevator

Parking

Ample parking available within walking distance



FLOOR PLAN

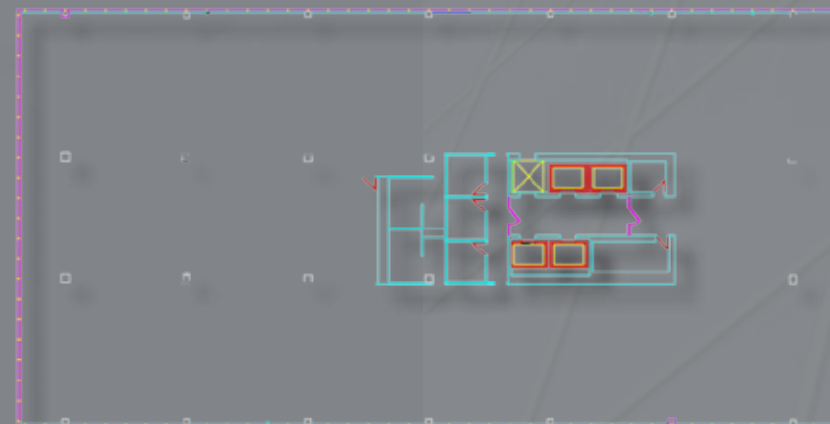

AMENITIES

- Immediate access to I-70/I-35 ramps
- Easy access to the airport via I-29 blocks away and other parts of the KC Metro area
- Four blocks from the Power & Light entertainment district
- Walking distance to numerous shops, restaurants, groceries, and residential